

General Relay

Main technical parameter

Model		55.34	57.02	57.04
Specifications				
Terminal layout		4Z	2Z	4Z
Contact capacity	AC	5A 250V	10A 250V	5A 250V
	DC	5A 30V	10A 30V	5A 30V
Contact resistance(mΩ)		≤50mΩ	≤50mΩ	≤50mΩ
Insulation resistance(MΩ)		≥100MΩ	≥100MΩ	≥100MΩ
Dielectric strength	BOC	1000VAC	1000VAC	1000VAC
	BCC	1500VAC	1500VAC	1500VAC
Coil nominal voltage	AC	6 to 240V	6 to 240V	6 to 240V
	DC	6 to 110V	6 to 110V	6 to 110V
Coil nominal power	AC	0.9VA to 1.2VA	0.9VA to 1.2VA	0.9VA to 1.2VA
	DC	≤0.9W	≤0.9W	≤0.9W
Electrical life(OPS)		10 ⁵	10 ⁵	10 ⁵
Mechanical life(OPS)		10 ⁷	10 ⁷	10 ⁷
Operating temperature(°C)		-40~+60	-40~+60	-40~+60
Weight(g)		≤35	≤35	≤35
Mounting methods		Printed-circuit board, Flange, Outlet	Printed-circuit board, Flange, Outlet	Printed-circuit board, Flange, Outlet



55.34



57.02



57.04

Dimension

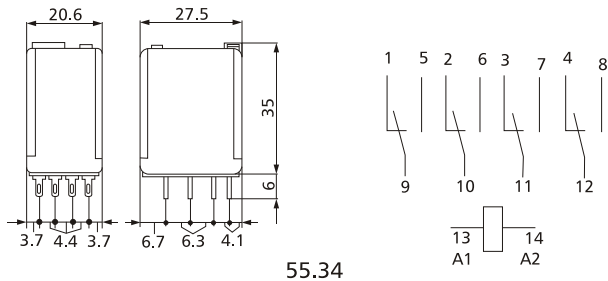

55.34

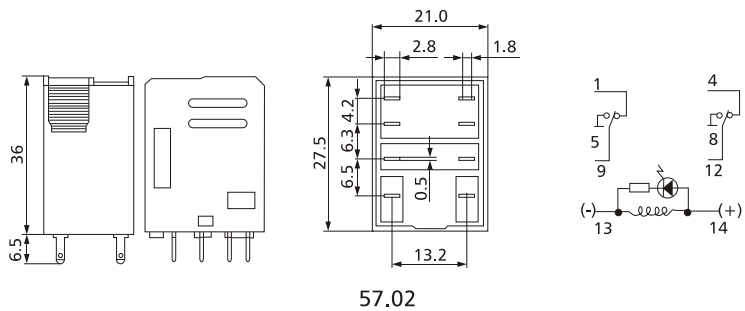

57.02

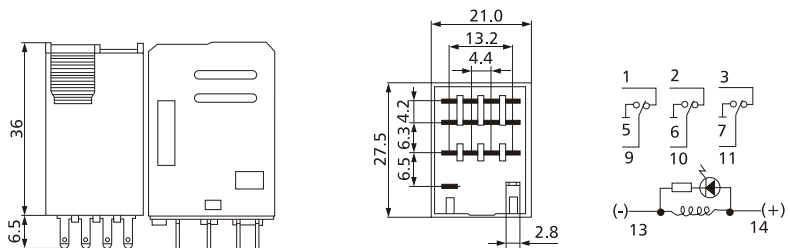

57.04